

COUNTY OF NEWBERRY
Purchasing Office, 1309 College Street, Post Office Box 156, Newberry S.C. 29108
Ph: (803) 321-2100 / Fax: (803) 321-2102

BIDDERS SCHEDULE

BID NUMBER: 2009-22

DATE: October 26, 2009

OPENING DATE AND TIME: November 9, 2009 at 11:00 a.m.

OPENING LOCATION: Newberry County Court House Annex
Conference Room 1309 College Street
Newberry, SC 29108

PROCUREMENT: Provide for the complete installation of six (6) vertical passive gas vents at the Newberry County Solid Waste Landfill.

*This solicitation will act as the contract for the project.

*By signing below, the signer has the authority to enter into an agreement with Newberry County and will be responsible for the fulfillment of the services stated in this solicitation.

BIDDER: _____ **SIGNATURE:** _____

Address: _____

Phone & Fax: _____

FEIN: _____

SC Contractor's License Number: _____

INSTRUCTIONS TO BIDDERS

1. Only one copy of bid is required unless otherwise specified.
2. Bids, amendments thereto or withdrawal request must be received by the time advertised for bid openings to be timely filed. It is the vendor's sole responsibility to insure that these documents are received by the County at the time indicated in the bid document.
3. When specifications or descriptive papers are submitted with the bid, enter bidder's name thereon.
4. Submit your signed bid on the bidder's schedule provided. Show bid number on envelope as instructed and the bid name or description. Newberry County accepts no responsibility for unmarked or improperly marked envelopes.
5. Bidders must clearly mark as "Confidential" each part of their bid which they consider to be proprietary information that could be exempt from disclosure under Section 30-4-40 Code of Laws of South Carolina, 1976, as amended, (also known as the Freedom of Information Act). The County reserves the right to determine whether this information should be exempt from disclosure and no legal action may be brought against the County or its agents for its determination in this regard.
6. By submission of a bid, you are guaranteeing that all goods and services meet the requirements of the solicitation during the contract period.
7. Tie bids will be resolved in accordance with the provisions of the Newberry County Purchasing Ordinance.
8. A copy of the bidder's W-9 shall be included in the submission.
9. If there are addenda issued; receipt and acknowledgement will be made in writing to the County of Newberry.

GENERAL PROVISIONS

1. The County of Newberry reserves the right to reject any and all bids, to cancel a solicitation, and to waive any technicality if deemed to be in the best interest of the County.
2. Unit prices will govern over extended prices unless otherwise stated in this bid invitation.

3. **PROHIBITION OF GRATUITIES:** South Carolina law and the Newberry County Purchasing Ordinance prohibit the giving of anything of value in return for favors or other preferential treatment in the purchasing process. Bidders should govern themselves accordingly.
4. **BIDDERS QUALIFICATION:** Bidders must, upon request of the county, furnish satisfactory evidence of their ability to furnish products or services in accordance with the terms and conditions of these specifications. The County reserves the right to make the final determination as to the bidder's ability to provide the products or services requested herein. Bidder determined to be irresponsible bidders are not allowed to bid to provide the County goods or services.
5. **BIDDERS RESPONSIBILITY:** Each bidder shall fully acquaint himself with conditions relating to the scope and restrictions attending the execution of the work under the conditions of this bid. It is expected that this will sometimes require on-site observation. The failure or omission of a bidder to acquaint himself with existing conditions shall in no way relieve him of any obligation with respect to this bid or to the contract.
6. **AWARD CRITERIA:** The contract shall be awarded to the lowest responsible and responsive bidder(s) whose bid meets the requirements and criteria set forth in the Invitation for Bid. Award may be made to one or a multiple of bidders, whichever deems to be in the best interest of the County, or unless otherwise stated on the bidder's schedule.
7. **WAIVER:** The County reserves the right to waive any Instruction to Bidders, General or Special Provisions, General or Special Conditions, or specifications deviation if deemed to be in the best interest of the county.
8. **COMPETITION:** This solicitation is intended to promote competition. If any language, specifications, terms and conditions, or any combination thereof restricts or limits the requirements in this solicitation to a single source, it shall be the responsibility of the interested vendor to notify the Purchasing Director in writing within five (5) days prior to the opening date. The solicitation may or may not be changed but a review of such notification will be made prior to the award.
9. **REJECTION:** Ambiguous bids which are uncertain as to terms, delivery, quantity, or compliance with specifications may be rejected or otherwise disregarded if such action is in the best interest of the County.
10. **RIGHT TO PROTEST:** With regard to any goods or services valued at over \$15,000.00 procured through sealed bid method only, any actual or prospective

bidder, offerer, contractor, or subcontractor who is aggrieved in connection with the solicitation or award of a contract may protest to the Purchasing Director. The protest, setting forth the grievance, shall be submitted in writing within 10 days after the aggrieved persons know or should have known of the facts giving rise thereto.

GENERAL CONDITIONS

1. **DEFAULT:** In case of default by the contractor, the County reserves the right to purchase any or all items in default in the open market, charging the contractor with any excessive costs. Should such charge be assessed, no subsequent bids of the defaulting contractor will be considered until the assessed charge has been satisfied.
2. **NON-APPROPRIATION:** Any contract entered into by the County resulting from this bid invitation shall be subject to cancellation without damages or further obligation when funds are not appropriated or otherwise made available to support continuation of performance in a subsequent fiscal period or appropriated year.
3. **HOLD HARMLESS AND INSURANCE:** The successful bidder shall indemnify and hold harmless the County of Newberry and all County officers, agents and employees against all suits or claims for personal injury or property damage resulting from, or arising from, the successful bidder's performance of the contract, as well as against any suits or claims of any character brought against the County or its agents or employees by reason of any claim of infringement of any patent, trade mark, trade dress, or copyright, including reimbursement to the County for all attorneys fees and court costs incurred by the County in defending itself or its agents or employees against any such claim or suit. In addition, the successful bidder will maintain a public liability policy with minimum limits of \$500,000 per occurrence, or \$1,000,000 single limit, for damages arising from acts which occur during the contract period, with the County of Newberry named as an additional insured; the successful bidder shall also maintain workers compensation and vehicle liability insurance in the amounts required by statutory law. Proof of such coverage will be provided upon demand or as otherwise provided in the bid specifications.
6. **FORCE MAJEURE:** The Contractor shall not be liable for any excess costs if the failure to perform the contract arises out of causes beyond the control and without fault or negligence of the contractor. Such causes may include, but are not restricted to acts of God or of a public enemy, acts of Government in either its sovereign or contractual capacity, fires, floods, epidemics, quarantine restrictions, strikes, freight embargoes, and unusually severe weather; but in every

case the failure to perform must be beyond the control and without the fault or negligence of the contractor. If the failure to perform is caused by default of a subcontractor, and if such default arises out of causes beyond the control of both the contractor and subcontractor and without excess costs for failure to perform, unless the supplies or services to be furnished by the subcontractor were obtainable from other sources in sufficient time to permit the contractor to meet the required delivery schedule.

7. **PUBLIC RELEASE:** Contractor agrees not to refer to award of this contract in commercial advertising in such a manner as to state or imply that the products or services provided are endorsed or preferred by the User.

8. **QUALITY OF PRODUCT:** Unless otherwise indicated in this bid it is understood and agreed that any items offered or shipped on this bid shall be new, in first class condition, and without defect that all containers shall be new and suitable for storage or shipment, and that prices include standard commercial packaging and shipping to the specified destination in Newberry County. No demonstration models shall be sold as new, without prior written permission of the County.

9. **S.C. LAW CLAUSE:** Upon award of a contract under this bid, the person, partnership, association or corporation to whom the award is made must comply with the laws of South Carolina which require such person or entity to be authorized and/or licensed to do business with this State. Notwithstanding the fact that applicable statutes may exempt or exclude the successful bidder from requirements that it be authorized and/or licensed to do business in this State, by submission of this signed bid, the bidder agrees to subject himself to the jurisdiction and process of the courts of the State of South Carolina as to all matters and disputes arising or to arise under the contract and the performance thereof, including any questions as to the liability for taxes, licenses, or fees levied by the State.

10. **AFFIRMATIVE ACTION:** The successful bidder will take affirmative action in complying with all Federal and State requirements concerning fair employment of the handicapped, and concerning the treatment of all employees, without regard or discrimination by reason of race, color, religion, sex, national origin or physical handicap.

11. **DELIVERIES:** All deliveries shall be FOB Destination. It is agreed by the parties hereto that delivery by the contractor to the common carrier does not

constitute delivery to the County. Any claim for loss or damage shall be between the contractor and the carrier.

12. **APPROPRIATE S.C. SALES TAX** shall be included as a line item in the bid unless other wise noted in the request from the County. The rate for Newberry County is 7%.
13. **PAYMENT TERMS:** Payment will be made within thirty (30) days of acceptance of the completed order. The County does not pay in advance for any item or service without prior permission from the Finance Director for Newberry County.
14. **BID BOND:** For each bid in excess of \$25,000.00 each bidder will submit with their bid a bond in the amount of 5% of the total price of the bid submitted. The bid bonds will be returned to the unsuccessful bidders once the county accepts the lowest most responsive bid. If the most responsive bidder fails to perform the responsibility of the bid within 10 days of the award, then the bid bond will be forfeited to the county as liquidated damages and the next lowest bidder will be awarded the bid. Bid bonds may be in the form of a surety, a cashier's check or an unconditional letter of credit in favor of Newberry County issued by a commercial bank in South Carolina.

Specifications for vents:

The Newberry County Department of Public Works is requesting bids for the installation of six (6) vertical passive gas vents at the closed Newberry County Solid Waste Landfill. The subject site is located at 432 Cockrell Road, Newberry, South Carolina approximately 2 miles east of the City of Newberry and approximately 40 miles northwest of Columbia, South Carolina. Newberry County operated the landfill until December 1993 when it stopped accepting waste at this facility and operations began at the Newberry County Transfer Station. The Newberry County Transfer Station is located approximately 0.1 miles east of Interstate I-26 along SC Highway 34. An aerial image of the subject site is included in Appendix 1 as Figure 1.

The landfill is currently leased to the Triangle Gun Club and is used for competitive skeet shooting. There are no permanent residents at the facility and the gun range is only open periodically throughout the week (usually on Wednesdays). The configuration of the facility is shown in the Site Plan in Appendix 1 as Figure 2.

Public Works proposes to initially install a total of six (6) passive gas vents on approximately 150-foot centers along the perimeter of the Phase II cells from just north of GMP-6 to just northeast of GMP-5 as depicted in Figure 3 of Appendix 1.

The vents would be constructed by first drilling a nominal 36-inch diameter borehole through the landfill cover material to an approximate depth of 30 feet (or less if saturated conditions are encountered at a shallower depth) with a bucket auger or similar type drill rig. A slotted, six-inch diameter, schedule 40 PVC riser would be inserted into the borehole; the riser section would extend to within approximately four feet of the top of the landfill cover and the annular space between the exterior of the riser and borehole wall would be backfilled with pea gravel or similar aggregate. The backfill would extend upward to a minimum of one-foot above the slotted riser and bentonite and cement seal would be placed immediately above the backfill material.

FORMER NEWBERRY CO. MSW LANDFILL
 SCDHEC Solid Waste Permit #: DWP-117
 432 Cockrell Road, Newberry, SC



**FIGURE 1
 SITE LOCATION**

FORMER NEWBERRY COUNTY MSW LANDFILL
 432 Cockrell Road
 Newberry, South Carolina
 SCDHEC Solid Waste Permit #: DWP-117



*... providing our clients with the best services available,
 actually understanding our clients objectives,
 and making their objectives our own!*

PO Box 25
 Summerville, South Carolina 29484
 (800) 325-0605 (843)-873-8200 fax: (843)-873-8765

SIZE B	TERRY Project No. 2314A	DWG NO. Figure 1 Site Location.dwg	REV
-----------	----------------------------	---------------------------------------	-----

SCALE: NOT TO SCALE

DATE: JUNE 2009

LEGEND:

- ◀ GAS MONITORING POINT
- WATER WELL (ABANDONED)
- PROPERTY BOUNDARY
- METHANE VENTING TRENCH
- O2 % OXYGEN
- CO2 % CARBON DIOXIDE
- CH4 % METHANE
- LEL % LEL

READINGS COLLECTED MARCH 12 AND 13, 2009.

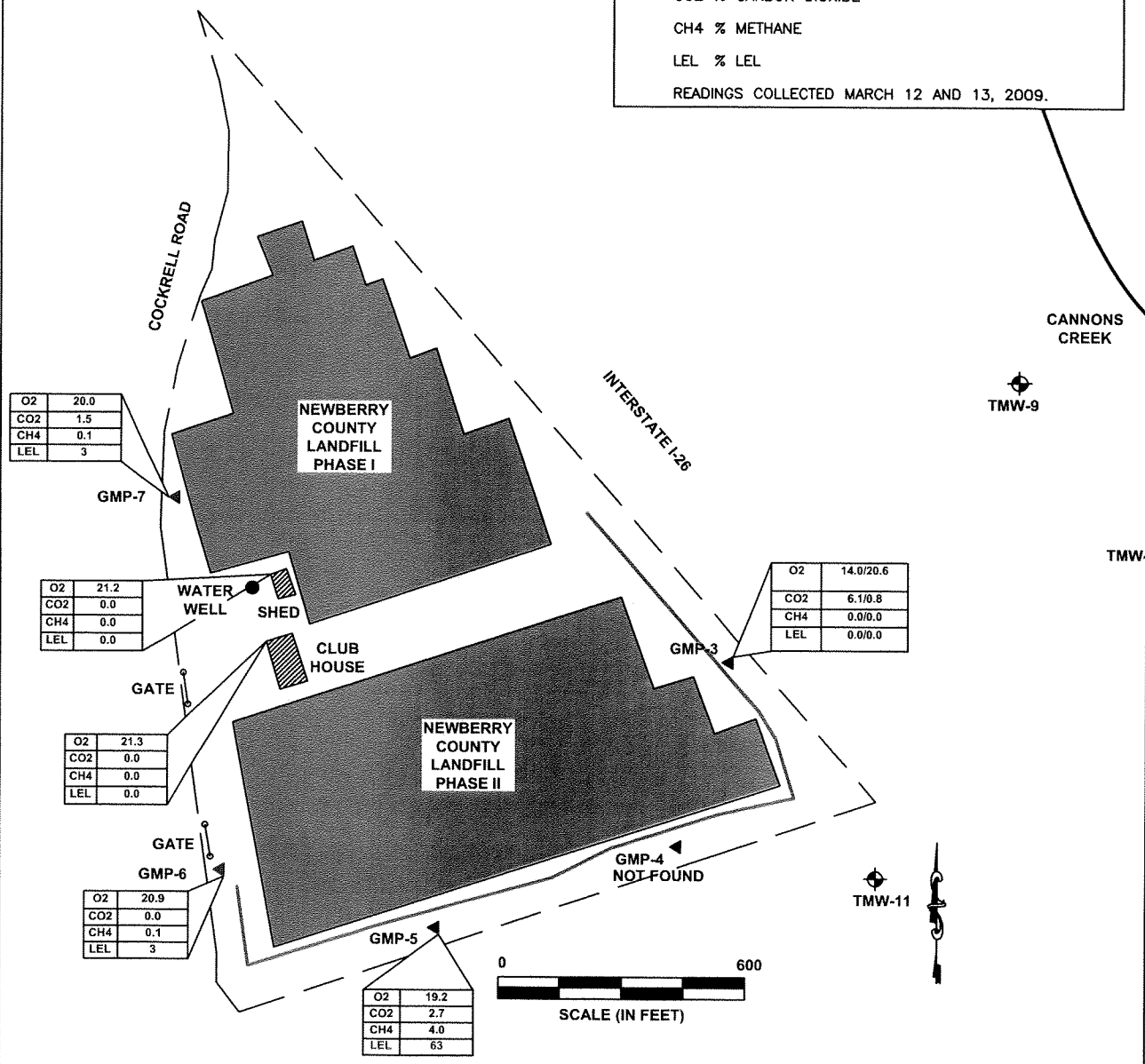

**FIGURE 2
SITE PLAN**

**FORMER NEWBERRY COUNTY MSW LANDFILL
432 Cockrell Road
Newberry, South Carolina
SCDHEC Solid Waste Permit #: DWP-117**

*... providing our clients with the best services available,
actually understanding our clients objectives,
and making their objectives our own!*

PO Box 25
Summerville, South Carolina 29484
(800) 325-0605 (843)-873-8200 fax: (843)-873-8765

SIZE B	TERRY Project No. 2314A	DWG NO.	REV
SCALE: 1 inch = 400 feet		DATE: JUNE 2009	

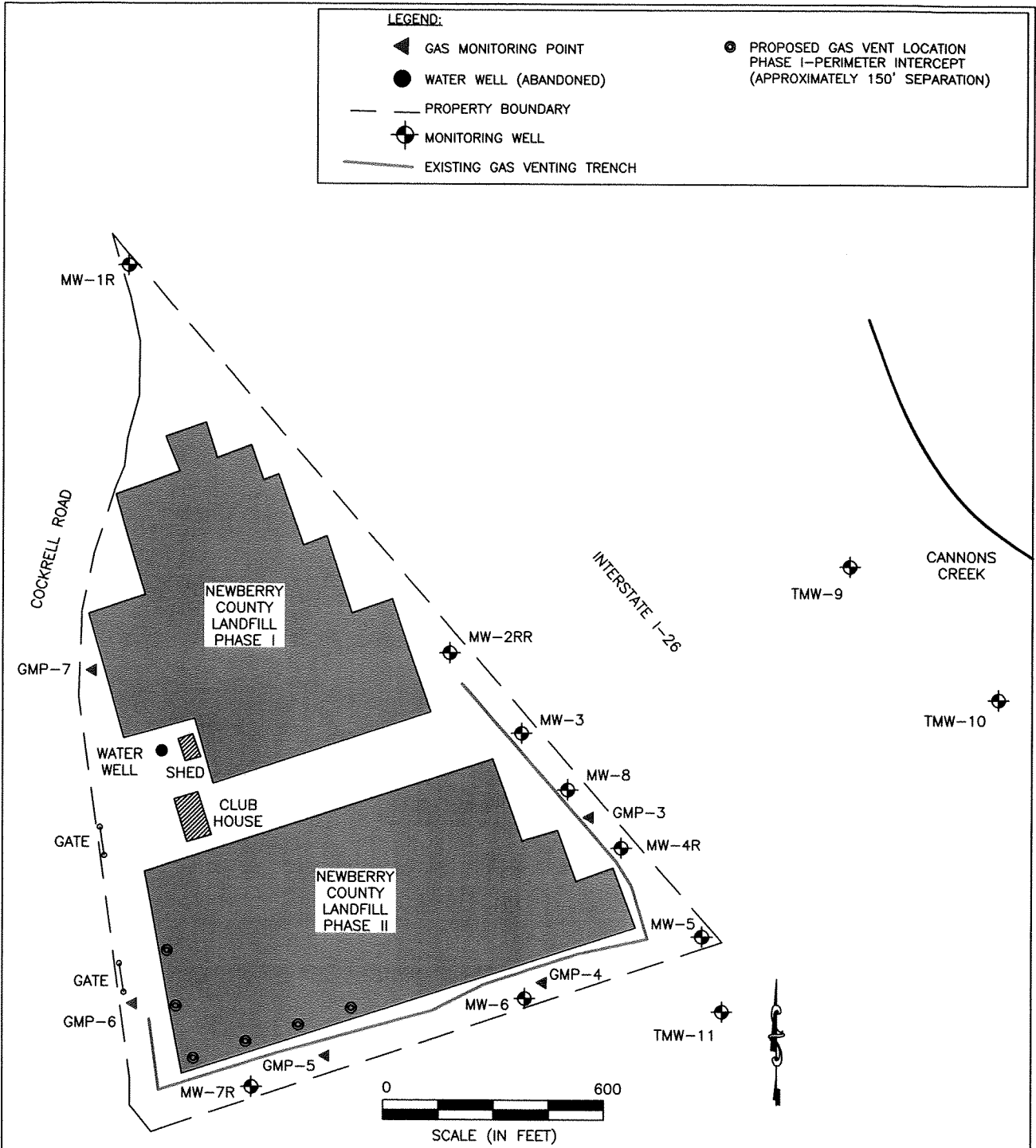

FIGURE 3
PROPOSED METHANE VENT LOCATIONS

FORMER NEWBERRY COUNTY MSW LANDFILL
 432 Cockrell Road
 Newberry, South Carolina
 SCDHEC Solid Waste Permit #: DWP-117



*... providing our clients with the best services available,
 actually understanding our clients objectives,
 and making their objectives our own!*

PO Box 25
 Summerville, South Carolina 29484
 (800) 325-0605 (843)-873-8200 fax: (843)-873-8765

SIZE B	TERRY Project No. 2314A	DWG NO.	REV
SCALE: 1 inch = 400 feet		DATE: JUNE 2009	

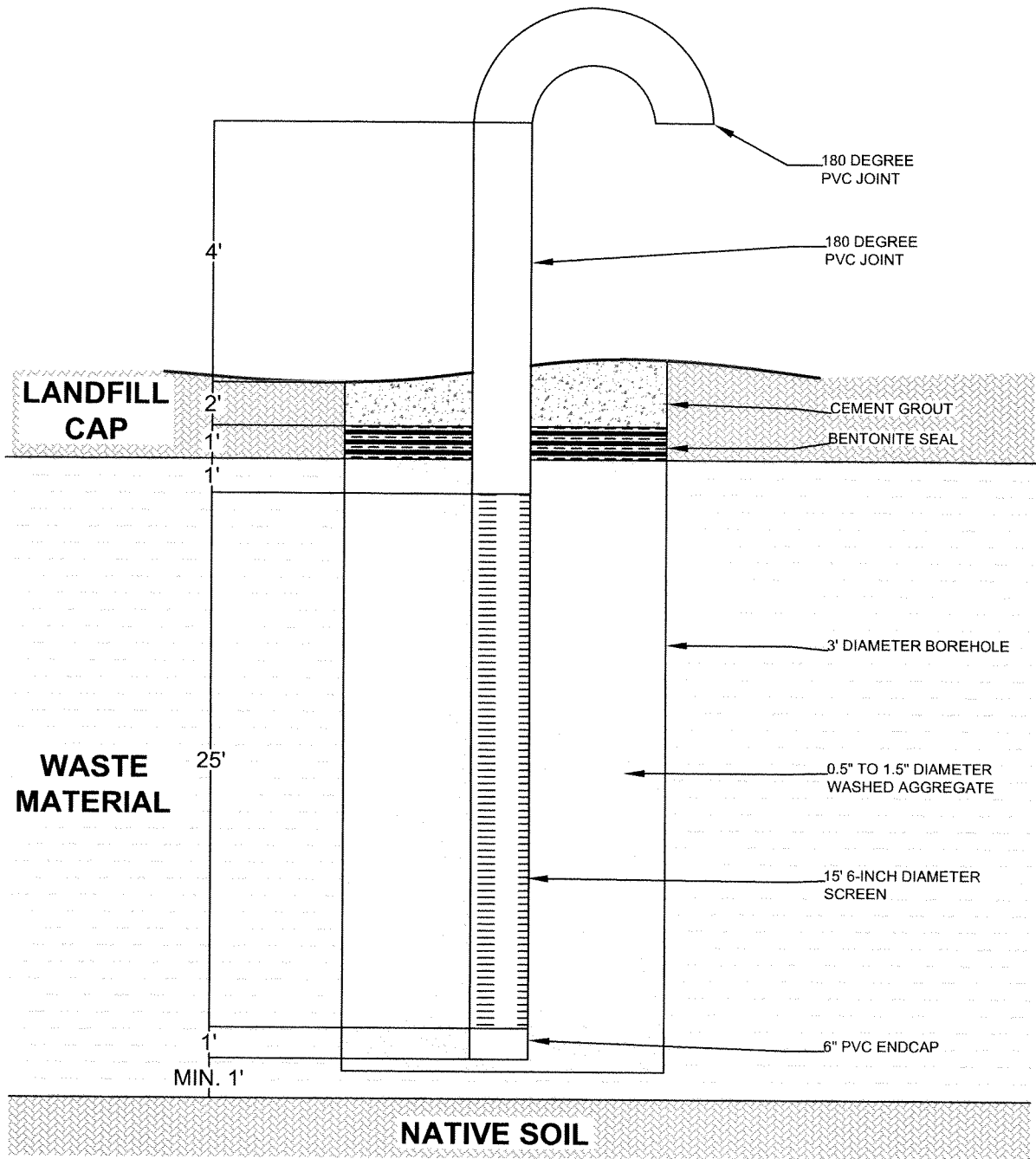

FIGURE 4
METHANE GAS VENT SCHEMATIC

FORMER NEWBERRY COUNTY MSW LANDFILL
 432 Cockrell Road
 Newberry, South Carolina
 SCDHEC Solid Waste Permit #: DWP-117



*... providing our clients with the best services available,
 actually understanding our clients objectives,
 and making their objectives our own!*

PO Box 25
 Summerville, South Carolina 29484
 (800) 325-0605 (843)-873-8200 fax: (843)-873-8765

SIZE
 B

TERRY Project No.
 2314A

DWG NO.

REV

SCALE: AS SHOWN

DATE: JUNE 2009